

REVISION DATA		
REV	DESCRIPTION	DATE
A0	NEW DRAWING	16-4-19

Technical Data

Material:

Pin(outer sleeve): Brass, machined CuZn38Pb2

Plating(outer sleeve):

Tin Plated:  $2\mu\text{m}/80\mu\text{m}^{\circ}\text{Ni}$ ,  $5\mu\text{m}/200\mu^{\circ}\text{Sn}$

Gold Plated:  $2\mu\text{m}^{\circ}/80\mu\text{m}^{\circ}\text{Ni}$ ,  $0.8\mu^{\circ}$  gold

Plating(Contact):  $2\mu\text{m}/80\mu^{\circ}\text{Ni}$ , gold or Tin plated

Insulator: PPS UL94V-0

Clip(Contact 6 Finger): Beryllium copper, heat treated

Electrical:

Current rating: 3Amps/contact max.

Contact resistance:  $\leq 4\text{m}\Omega$ /contact

Insulation resistance:  $\geq 1000\text{M}\Omega$  at  $V=100\text{V}$

Dielectric Withstanding Voltage: 1000V AV Min

Operating voltage: 60VAC/DC

Mechanical:

Average Insertion force with steel pin of  $\varnothing 0.66\text{mm}/0.38^{\circ}$ :  $< 250\text{g}$

Average withdrawal force with steel pin of  $\varnothing 0.66\text{mm}/0.38^{\circ}$ :  $< 70\text{g}$

Mechanical life cycle: min 200

Operating temperature:  $-40^{\circ}\text{C}$  to  $+105^{\circ}\text{C}$

Soldering temperature:  $+255^{\circ}\text{C}$

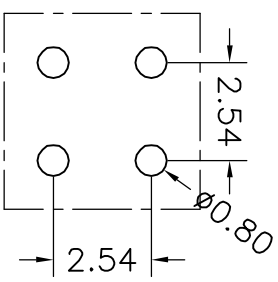
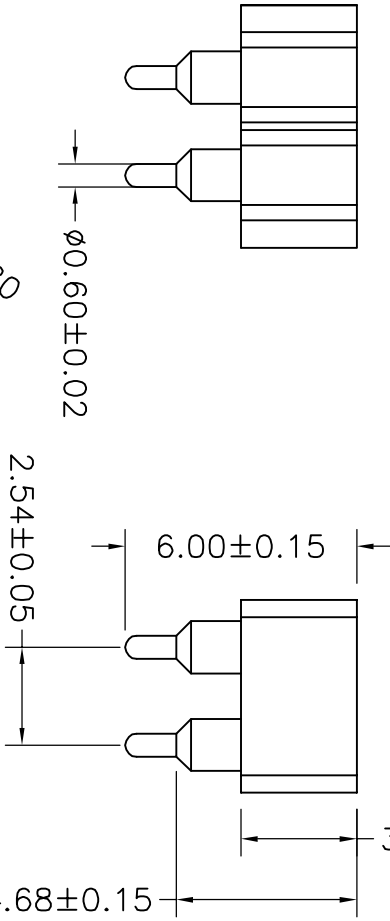
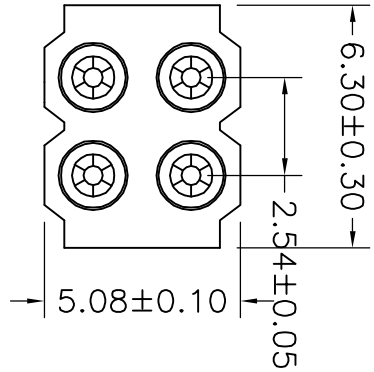

P.C.B LAYOUT

Q2T	X	X	-	X	XX	XX	XXXX	X
Pitch (mm) A=1.27 B=1.78 C=2.00 D=2.54	Insulator Type code 1=Single row 2=Double row 3=Three row	Angel Options D=80° R=90° S=SMT I=IC	No. of Positions XX	Pin plated T1=Tin 150u" T2=Tin 200u" G1=6/P G2=Gold 3u" G3=Gold 10u" G4=Gold 15u" G5=Gold 30u"	ClIP plated T1=Tin 150u" T2=Tin 200u" G1=6/P G2=Gold 3u" G3=Gold 10u" G4=Gold 15u" G5=Gold 30u"	Pin Length Options 0600=6.00mm S=SMT	Specifications A=Public seat B=Female seat	

TOLERANCE

X, XXX	±0.05
X, XX	±0.15
X, X	±0.20
X,	±0.30
ANGLE	±5.0°

PROJECTION

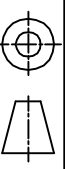

DATE:	2016-5-18
DRAWN:	TANG-S-G

TITLE:

Double socket connector 2.54mm  
1-6.00mm 塑胶宽度6.30mm

PART NO:	QZTD2-D04XXXX0600B-2
DRAWING NO:	2016051806

APPROVED:	REV:	A0	UNIT:	mm	SCALE:	FULL	SIZE:	A4
-----------	------	----	-------	----	--------	------	-------	----

**qzconn** 东莞启之泰电子科技有限公司  
启之泰