

2

3

4

5

6

7

REVISION DATA		
REV	DESCRIPTION	DATE
A0	NEW DRAWING	16-4-21

Technical Data

Material:

Pin(outer sleeve): Brass, machined CuZn38Pb2

Plating(outer sleeve):

Tin Plated: 2µm/80µm Ni, 5µm/200µm Sn

Gold Plated: 2µm"/80µm Ni, 0.8µ" gold

Plating(Contact): 2µm/80µ"Ni, gold or Tin plated

Insulator: PPS UL94V-0

Clip(Contact 4 Flinger): Beryllium copper, heat teated

Electrical:

Current rating: 3Amps/contact max.

Contact resistance: ≤4mΩ/contact

Insatiation resistance: ≥1000MΩ at V=100V

Operating voltage: 60VAC/DC

Mechanical:

Average Insertion force with steel pin of ø0.432: <250g

Average withdrawal force with steel pin of ø0.432: >70g

Mechanical lige cycle: min 200

Operating temperature: -40° C to +105° C

Soldering temperature: +255° C

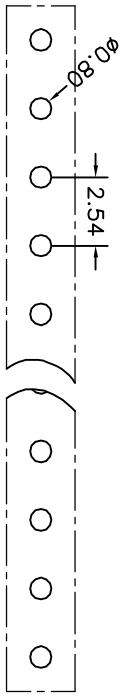
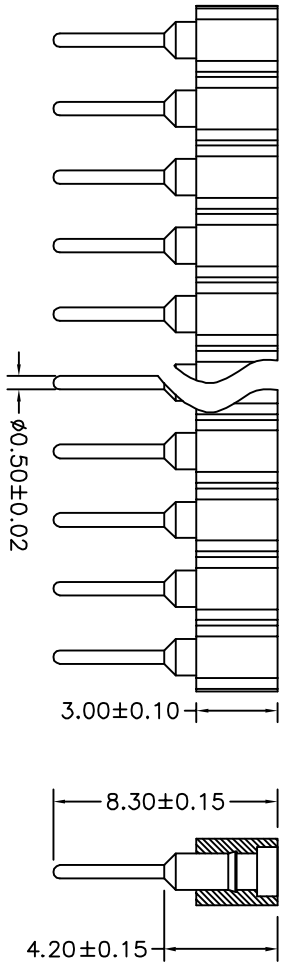
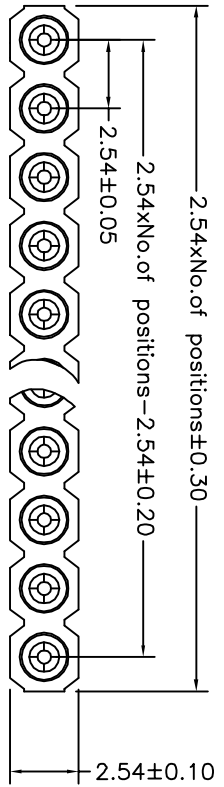

P. C. B LAYOUT

QZT7	X	X	-	X	XX	XX	XX	XXXX	X
Pitch(mm) A=1.27 B=1.778 C=2.00 D=2.54	Insulator Type code 1=Single row 2=Double row 3=Three row	Angel Options D=180° R=90° S=SMT I=IC	No. of Positions XX positions	Pin plated T1=Tin 150µ" T2=Tin 200µ" G1=6/F G2=Gold 3µ" G3=Gold 10µ" G4=Gold 15µ" G5=Gold 30µ"	CLIP plated T1=Tin 150µ" T2=Tin 200µ" G1=6/F G2=Gold 3µ" G3=Gold 10µ" G4=Gold 15µ" G5=Gold 30µ"	Pin Length Options 0830-8.30mm	Specifications A=Public seat B=Female seat		

dzttcom 东莞启之泰电子科技有限公司

TOLERAVCE	PROJ ECTON	TITLE:
X. XXX ±0.05	DATE: 2016-4-21	Single row socket connector 2.54mm 1-8.30mm
X. XX ±0.15	DRAWN: TANG-S-G	PART NO: QZTD1-DXXXXXX0830B
X. X ±0.20	CHECKED:	DRAWING NO: 2016042105
X. ±0.30	APPROVED:	REV: A0 UNIT: mm SCALE: FULL SIZE: A4
ANGLE ±5.0°		

A

B

C

D

E

A

C

D

E

1

2

3

4

5

6

7