

2

3

4

5

6

7

REVISION DATA		
REV	DESCRIPTION	DATE
A0	NEW DRAWING	16-4-15

Technical Data

Material:

Pin(outer sleeve):Brass, machined CuZn38Pb2

Plating(outer sleeve):

Tin Plated:2μm/80μm"Ni, 5μm/200μ"Sn

Gold Plated:2μm"/80μm"Ni, 0.8μ" gold

Plating(Contact):2μm/80μ"Ni, gold or Tin plated

Insulator:PPS UL94V-0

Clip(Contact 4 Finger):Beryllium copper, heat teated

Electrical:

Current rating:3Amps/contact max.

Contact resistance:≤4mΩ/contact

Insulation resistance:≥1000MΩ at V=100V

Operating voltage:60VAC/DC

Mechanical:

Average Insertion force with steel pin of ∅0.432: <250g

Average withdrawal force with steel pin of ∅0.432: >70g

Mechanical life cycle:min 200

Operating temperature:-40° C to+105° C

Soldering temperature:+255° C

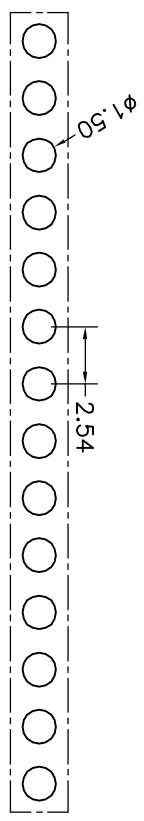
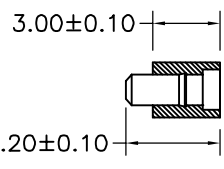
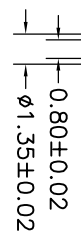
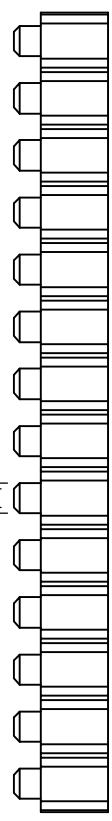
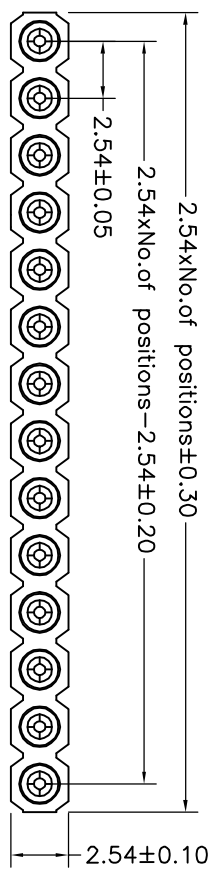

P. C. B LAYOUT

QZT	X	X	-	X	XX	XX	XX	XXX	X
Pitch(mm) A=1.27 B=1.778 C=2.00 D=2.54	Insulator Type code 1=Single row 2=Double row 3=Three row			Angel Options D=180° R=90° S=SMT I=IC	No. of Positions XX positions	Pin plated T1=Tin 150u" T2=Tin 200u" G1=6/F G2=gold 3u" G3=gold 10u" G4=gold 15u" G5=gold 30u"	CLIP plated T1=Tin 150u" T2=Tin 200u" G1=6/F G2=gold 3u" G3=gold 10u" G4=gold 15u" G5=gold 30u"	Pin Length Options 0/20=4,20mm	Specifications A=Public seat B=Female seat

Qztconn 东莞市启之泰电子科技有限公司

启之泰

TOLERAVCE

X,XXX	±0.05
X,XX	±0.15
X,X	±0.20
X,	±0.30
ANGLE	±5.0°

PROJECTON



TITLE:

Single row socket connector 2.54mm
L=4,20mm

DATE: 2016-4-15
DRAWN: TANG-S-G

PART NO: QZTD1-DXXXXXX0420B

CHECKED: DRAWING NO:2016041505

APPROVED:	REV: A0	UNIT: mm	SCALE: FULL	SIZE: A4
-----------	---------	----------	-------------	----------