

2

3

4

5

6

7

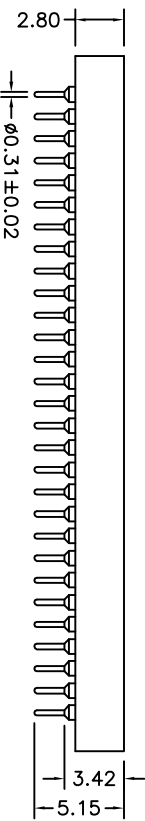
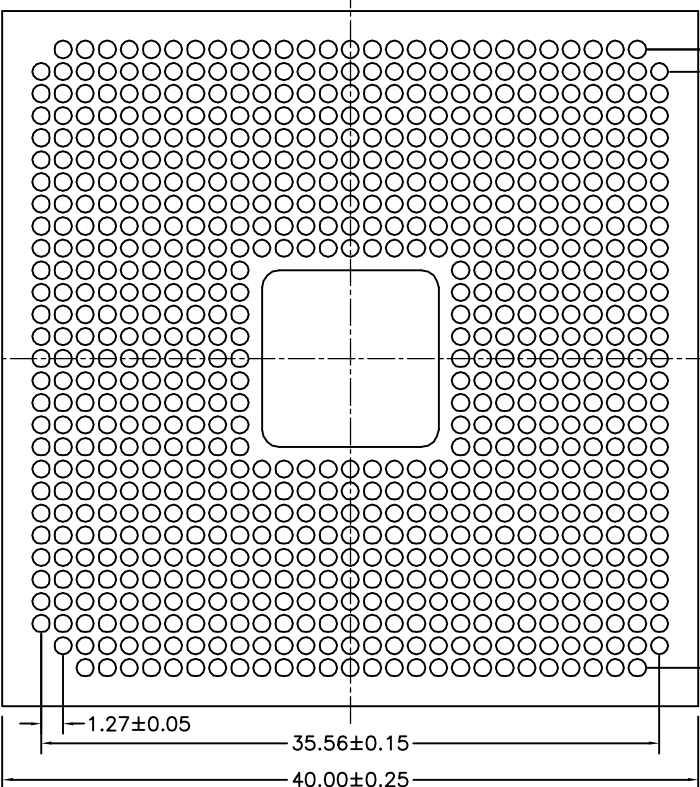
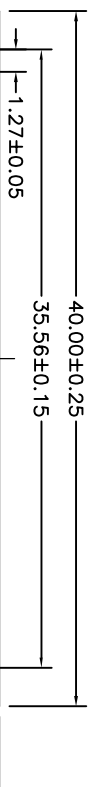

QZT	X	X	XXX	X	XX	XXX	X
Pinch (mm) A=2.54X2.54 B=2.54X1.27 C=1.27X1.27	Angel Options P=PA C1=PLCC-SMT C2=PLCC-DIP	No. of Positions XXX positions 754=754PIN	Pin plated T1=Tin 150u" T2=Tin 200u" G1=6/F G2=Gold 3u" G3=Gold 10u" G4=Gold 15u" G5=Gold 30u"	CLIP plated T1=Tin 150u" T2=Tin 200u" G1=6/F G2=Gold 3u" G3=Gold 10u" G4=Gold 15u" G5=Gold 30u"	Pin Length Options 0515=5.15mm	Specifications A=Public seat B=Female seat	

REVISION DATA		
REV	DESCRIPTION	DATE
A0	NEW DRAWING	16-5-17

Technical Data
Material:
 Pin(outer sleeve):Brass, machined CuZn38Pb2
 Plating(outer sleeve):
 Tin Plated:2µm/80µm"Ni, 5µm/80µ"Sn
 Gold Plated:2µm"/80µm"Ni, full gold
 Insulator:FR4 UL94V-0
 Clip(Contact 6 Flinger):Beryllium copper, heat teated

Electrical:
 Current rating:1amps/contact max.
 Contact resistance:≤4mΩ/contact
 Insulation resistance:≥1000MΩ at V=500V
 Dielectric Withstanding Voltage:1000V AV Min
 Operating voltage:60VAC/DC

Mechanical:
 Average Insertion force with steel pin of Ø0.31: <60g
 Average withdrawal force with steel pin of Ø0.31: >15g
 Operating temperature:-40° C to-105° C
 Soldering temperature:+255° C

dzconn 启之泰 东莞市启之泰电子科技有限公司

TOLERAVCE	PROJECTION	TITLE:
X,XXX ±0.05 X,XX ±0.15 X,X ±0.20 X, ±0.30 ANGLE ±5.0°	DATE: 2016-5-17 DRAWN: TANG-S-G	Pin grid array sockets 1.27x1.27mm 754PIN
CHECKED:	PART NO: QZTC-P754XXXX0515B	DRAWING NO: 2016051704
APPROVED:	REV: A0	UNIT: mm
	SCALE: 1:1	SIZE: A4
		PAGE: 1/2